

Typical Applications

- Wireless Telecom Systems
- IF & RF Applications

Main Features

- L-Band Coaxial Circulator
- Excellent Insertion Loss
- SMA Connectorized

Electrical Specifications

Parameter	Unit	Specification
Frequency Range	MHz	863 - 873
Isolation	dB	20 min
Insertion Loss	dB	< 0.4
VSWR		1.25 : 1 max
Forward Power	W	2 max CW
In/Out Impedance	Ohm	50 typ.

Mechanical Specifications

Parameter	Unit	Specification
RF connectors		SMA - Female
Finish		Nickle plated

Environment

Parameter	Unit	Specification
Operating Temperature	°C	-20°C to +70°C

Products and Product Information are Subject to Change Without Notice

TECHNIWAVE • Chemin de Montfort 78770 THOIRY France • Tél. : +33 (0)1 34 84 37 43 • E-mail : sales@techniwave.com • www.techniwave.com

TECHNIWAVE Proprietary Information • All rights reserved

Revision : 00

Date : November 20, 2015

TH868M10S01L

RF Coaxial Circulator

Outline drawing

All dimensions in mm

Direction : 1 to 2 to 3

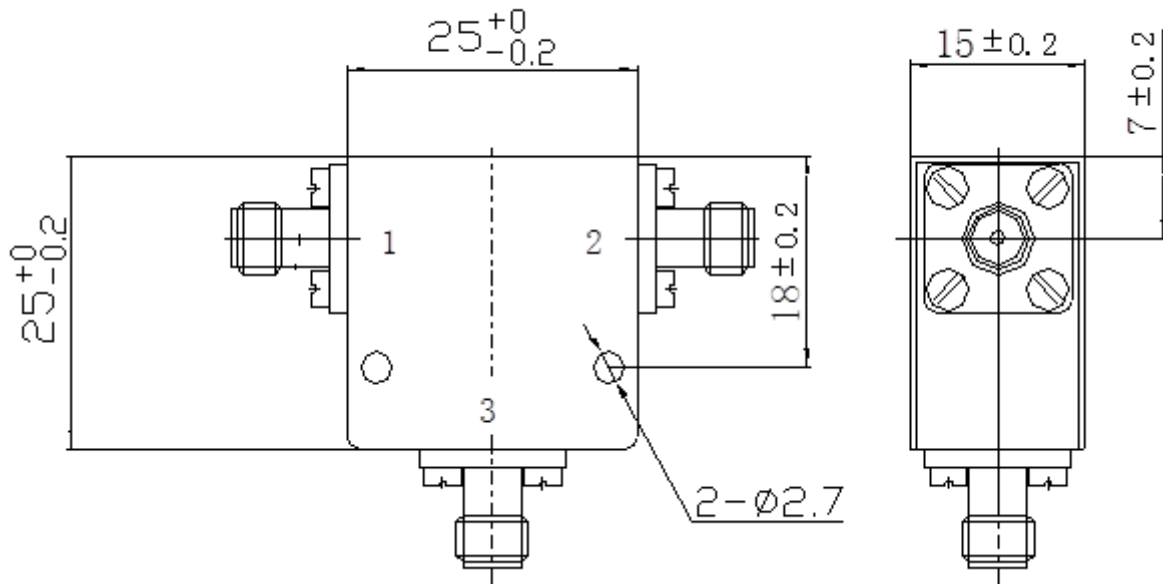

Products and Product Information are Subject to Change Without Notice